



Wireless universal transmitter RF 96 ST SW868 LBT Material number: 1441087

Features/Options:

- Thermoplastic enclosure
- Mounting details to EN 50047
- Plug-in connector M12
- sWave® wireless technology
- No wiring and pipe laying required
- Power supply by Lithium battery
- Easy programming of receiver
- Output signal can be individually configured at the receiver
- LBT - Listen before Talk software (necessary in conjunction with potential interference)

Notes

- The RF 96 ST may be used in combination with wireless inductive sensor RF IS or wireless magnetic sensor RF RC 20
- Connection of external switching contact (potentialfree contact) with gold contacts possible.
- Factory delivery with battery type SL-760 (AA)

Dimensions

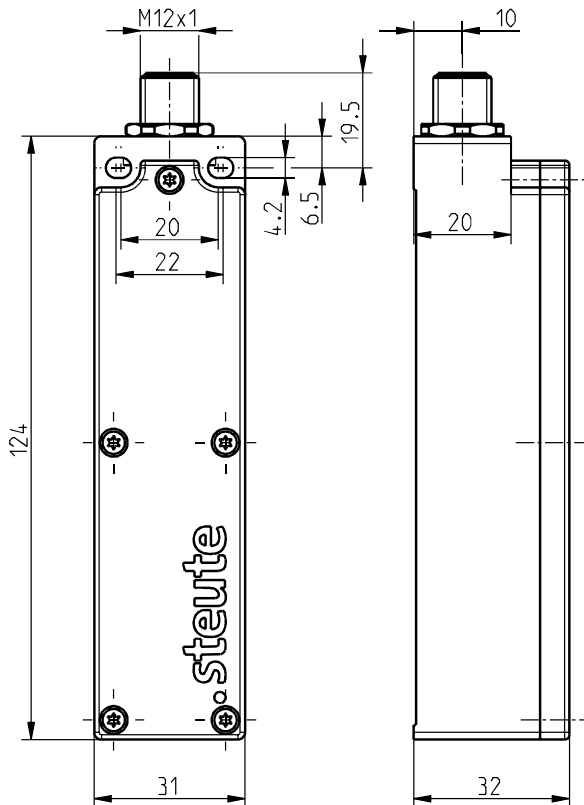

Technical data

Applied standards	EN 60947-5-1, EN 61000-6-2, EN 61000-6-3, EN 301 489-1, EN 301 489-3, EN 300 220-1, EN 300 220-2
Enclosure	thermoplastic, glass-fibre reinforced, impact resistant, self-extinguishing UL 94 V-0
Tightening torque	M4 enclosure mounting screws: max 1.2 Nm M2.5 cover screws: approx. 0.45 Nm
Degree of protection	IP 67 to IEC/EN 60529
Protocol	sWave®
Frequency	868.3 MHz (Europe, China)
Transmission power	< 25 mW
Data rate	66 kbps
Channel bandwidth	480 kHz
Voltage supply	lithium battery Tadiran SL-2770 (replaceable)
System	Li/SOCl ₂
Nominal voltage	3.6 V
Nominal capacity	8.5 Ah

Errors and omissions excepted.



Wireless universal transmitter
RF 96 ST SW868 LBT
Material number: 1441087

Technical data

Battery life	depending on operation cycles inductive sensor: 10 s - approx. 3.7 years 100 s - approx. 3.9 years 1,000 s - approx. 3.9 years magnetic sensor / external contact: 10 s - >10 years (max. manufacturer's specification of storage life)
Alternatively:	
Voltage supply	lithium battery Tadiran SL-760 (replaceable)
System	Li/SOCl ₂
Nominal voltage	3.6 V
Nominal capacity	2.2 Ah
Battery life	depending on operation cycles inductive sensor: 10 s - approx. 1.0 years 100 s - approx. 1.0 years 1,000 s - approx. 1.0 years magnetic sensor / external contact: 10 s - approx. 7.2 years 100 s - >10 years (max. manufacturer's specification of storage life)
Connection	plug-in connector M12 x 1, 4-pole
Connectable devices	RF IS M8, RF IS M12, RF IS M18, RF IS M30, RF RC 20, external switches using the connecting cable 1215497
Ambient temperature	-20 °C ... +65 °C
Operation cycles	max. 12000 telegrams with repetitions/h
Switching frequency	max. 5 Hz
Standby current	15 µA
Wireless range	max. 450 m outdoors, max. 40 m indoors
Actuating time	min. 80 ms
Note	status signal adjustable via jumper, no, 10 s, 100 s, 1000 s, 10000 s delivery state: jumper position without status signal, transmission of battery voltage and switching condition

Errors and omissions excepted.



Wireless universal transmitter RF 96 ST SW868 LBT Material number: 1441087

Technical data

Wireless approvals

Europe: RED 2014/53/EU

Weight

120 g

Plug-in configuration

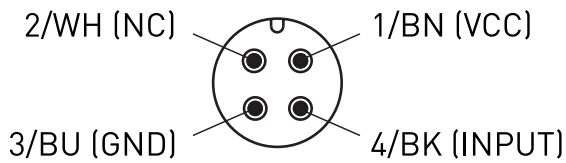

NC = not connected

Colour coding only valid for
coupling 4-poles mat. no. 1215497 and
coupling 4-poles mat. no. 1262873

External switch contact

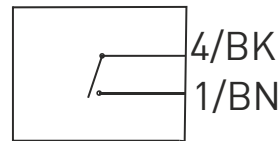

Sensors

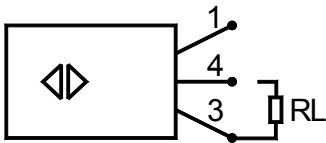

Errors and omissions excepted.